



Mobile Modular Management Corporation
11450 Mission Blvd.
Mira Loma, CA 91752
Phone: (951) 360-6600
Fax: (951) 360-6622
www.mobilemodular.com

Lease Quotation and Agreement

Quotation Number: 230712

Customer PO/Ref:

Date of Quote: 01/18/2019

Term: 12 Months

Sign up for the Easy Lease Option (see end of document for details)

Customer Information	Site Information	Mobile Modular Contact
Callexico USD 901 Andrade Avenue Callexico, CA 92231 Jimmy Sanders jimmy@sanders-inc.com	Callexico USD Callexico High School 1030 Encinas Avenue Callexico, CA 92231 Jimmy Sanders jimmy@sanders-inc.com	Questions? Contact: Dana Johnson dana.johnson@mobilemodular.com Direct Phone: (951) 360-6600 Fax: (951) 360-6622

Product Information	Qty	Monthly Rent	Extended Monthly Rent	Taxable
Classroom, 24x40 DSA (Item1001) <i>Right Hand Door Configuration. Open plan. Tackboard interior.</i>	1	\$1,350.00	\$1,350.00	N
Classroom, 48x40 DSA (NonStd) <i>Non-Standard Configuration. Size excludes 3' towbar.</i>	2	\$2,305.00	\$4,610.00	N
Charges Upon Delivery	Qty	Charge Each	Total One Time	Taxable
Classroom, 24x40 DSA (Item1001)				
Block and Level Building (B5) (PW)	1	\$4,520.00	\$4,520.00	N
Delivery Haulage Lowboy 12 wide	2	\$955.00	\$1,910.00	N
Line 228 Haulage (distance)	1	\$895.00	\$895.00	N
			<u>\$7,325.00</u>	
Classroom, 48x40 DSA (NonStd)				
Block and Level Building (B8) (PW)	2	\$8,625.00	\$17,250.00	N
Delivery Haulage Lowboy 12 wide	8	\$955.00	\$7,640.00	N
Line 228 Haulage (distance)	4	\$895.00	\$3,580.00	N
Line 79 Install carpet tile on return	426	\$29.70	\$12,652.20	N
Line 80 Install VCT (sq ft)	3,840	\$5.90	\$22,656.00	N
Line 92 Remove Carpet tile	426	\$4.07	\$1,733.82	N
Line 94 Remove VCT on return (sqft)	3,840	\$2.66	\$10,214.40	N
			<u>\$75,726.42</u>	
			Total	\$ 83,051.42
Charges Upon Return	Qty	Charge Each	Total One Time	Taxable
Classroom, 24x40 DSA (Item1001)				
Cleaning Fee	2	\$125.00	\$250.00	N
<i>Line 152 Piggyback</i>				
Prepare Equipment For Removal (B5) (PW)	1	\$3,415.00	\$3,415.00	N
Return Haulage Lowboy 12 wide	2	\$955.00	\$1,910.00	N
			<u>\$5,575.00</u>	
Classroom, 48x40 DSA (NonStd)				
Cleaning Fee	8	\$125.00	\$1,000.00	N
<i>Line 152 piggyback</i>				
Prepare Equipment For Removal (B8) (PW)	2	\$6,345.00	\$12,690.00	N
Return Haulage Lowboy 12 wide	8	\$955.00	\$7,640.00	N
			<u>\$21,330.00</u>	

Thank you for contacting Mobile Modular.

Mobile Modular is a division of McGrath RentCorp.
230712, 01-18-2019 10:24 AM prod

Lease Quotation and Agreement

Quotation Number: 230712

Customer PO/Ref:

Date of Quote: 01/18/2019

Term: 12 Months



Total \$26,905.00

Total Estimated Charges

Subtotal of Monthly Rent	\$5,960.00
Taxes on Monthly Charges	\$0.00
Total Monthly Charges (including tax)	\$5,960.00
Charges Upon Delivery (including tax)	\$83,051.42
Charges Upon Return (including tax)	\$26,905.00
Total One Time Charges (including tax)	\$109,956.42

Special Notes

DSA Classrooms include: (2) 8040 marker boards, (1) fire extinguisher at each exit, empty back box with conduit stubbed to ceiling for future pull station & horn, skirting for perimeter of building only, standard factory ramp, and wood sill foundation for level site.

Block/Level: Price assumes building is installed using Mobile Modular standard foundation. Mobile Modular assumes installation on the minimum foundation design criteria/tolerances. For DSA buildings, it is assumed building will be installed on the minimum amount of foundation lumber per the applicable DSA approved stockpile drawings and site will not exceed 4-1/2" out of level. Additional material and labor charges apply for installing buildings above minimum foundation design criteria, raising buildings to meet specific finish floor elevations, raising building level to adjacent buildings, landings, walkways, transitions, etc.

General: Customer's site must be dry, compacted, level and accessible by normal truck delivery. Pricing does not include any clearing or grading of sites, obstruction removal, site or final building clean up, any asphalt transitions, dolly, crane, forklift, electrical or plumbing connections, window coverings, furniture, casework, appliances, doorstops, phone or data lines, gutters, downspouts or tie-in, temporary power, temporary fencing, traffic control, flagmen, soil and/or pull test, custom engineering, fees associated with inspections, city or county submittals and/or use permits, security screens, door bars and any item not specifically listed as being included.

Floor Plans

Thank you for contacting Mobile Modular.

Mobile Modular is a division of McGrath RentCorp.

230712, 01-18-2019 10:24 AM prod

www.mobilemodular.com

Page 2 of 5

Lease Quotation and Agreement

Quotation Number: 230712
Customer PO/Ref:
Date of Quote: 01/18/2019
Term: 12 Months



Classroom, 48x40 DSA (NonStd)

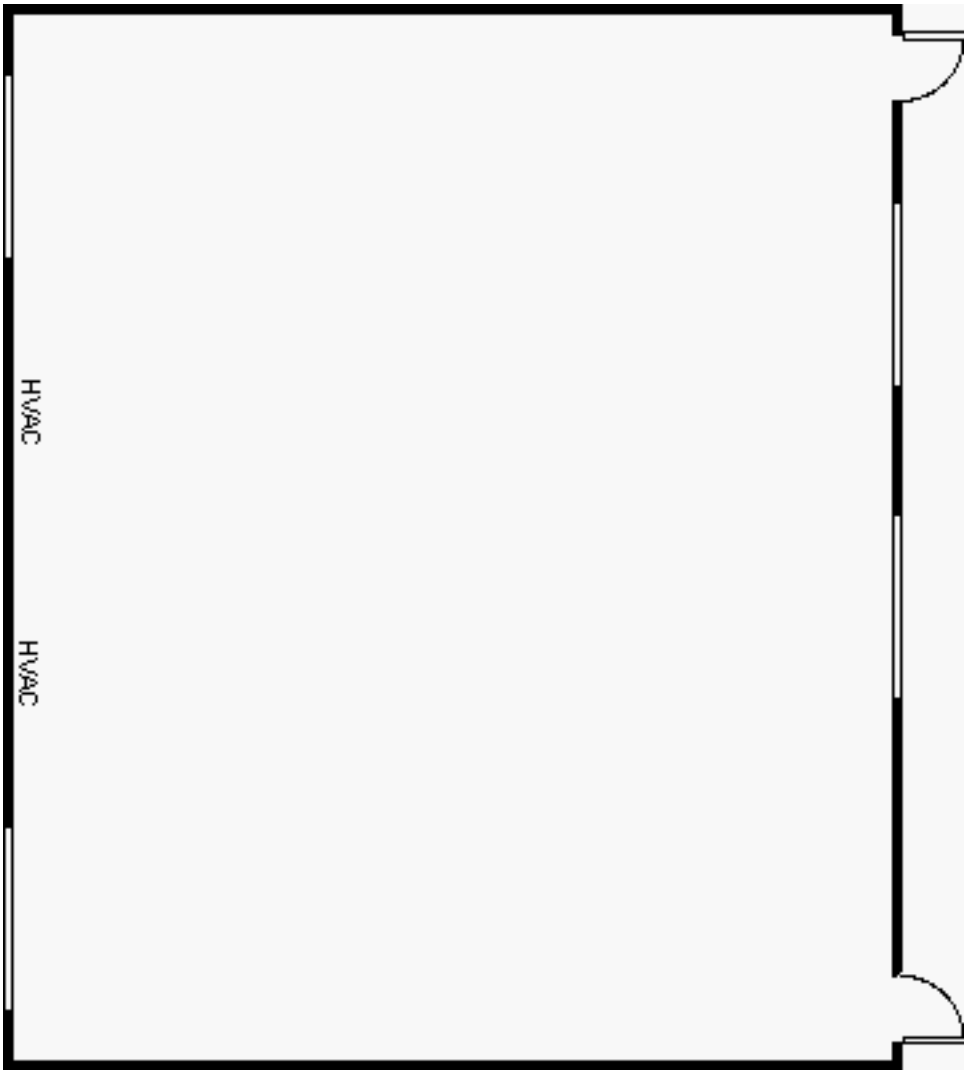

All drawings and specifications are nominal.

Lease Quotation and Agreement

Quotation Number: 230712

Customer PO/Ref:

Date of Quote: 01/18/2019

Term: 12 Months



Classroom, 24x40 DSA (Item1001)



All drawings and specifications are nominal.

Additional Information

- Quote is valid for 30 days.
- A minimum cleaning charge per floor will apply for modular buildings.
- Customer's site must be dry, compacted, level and accessible by normal truck delivery. Costs to dolly, crane, forklift, etc. will be paid by customer. Unless noted, prices do not include permits, ramp removal, stairs, foundation systems, foundation system removal, temporary power, skirting, skirting removal, engineering, taxes or utility hookups.
- Subject to equipment availability. Unless noted, equipment and related furnishings, finishes, accessories and appliances provided are previously leased and materials, dimensions, and specifications vary. Detailed specifications may be available upon request. For lease transactions, Mobile Modular reserves the right to substitute equal or better equipment prior to delivery without notice.
- This transaction is subject to prior credit approval and all terms, conditions, and attachments of MMMC's standard contract.
- Security deposit and payment in advance may be required.
- Rent will be billed in advance every 30 calendar days.
- **Sales Tax will be calculated based on the tax rate at the time of invoicing.**
- **Unless otherwise noted, prices do not include prevailing wages, Davis-Bacon wages, or other special or certified wages.**

Thank you for contacting Mobile Modular.

Mobile Modular is a division of McGrath RentCorp.
230712, 01-18-2019 10:24 AM prod

Lease Quotation and Agreement

Quotation Number: 230712

Customer PO/Ref:

Date of Quote: 01/18/2019

Term: 12 Months



Mobile Modular Easy Lease. Sign Me Up!

Getting your modular building on its way has never been easier... and faster. With Mobile Modular Easy Lease you can convert your Lease Quotation directly into a Lease Agreement by signing below. **It's as easy as 1, 2, 3, 4.** Once we receive your signed Easy Lease option, we'll finalize your building details and get your project on its way.

1. Review and acknowledge agreement.

This Quotation is subject to Mobile Modular Management Corporation, a California corporation, herein known as lessor (the "Lessor") credit approval of Customer, herein known as lessee (the "Lessee"). Lessor does not warrant that the equipment meets any local or state code not specifically listed herein. Equipment is subject to availability. By signing below, customer accepts the terms of this quotation including prices and specifications, and instructs Lessor to make appropriate arrangements for the preparation and delivery of the Equipment identified herein, and agrees that such signature constitutes customer's acceptance of and agreement to the Lessor's Lease. Such lease, and customer's agreement thereto, is subject to Lessor's standard terms and conditions located on the Lessor's web site at (www.mobilemodular.com/contractterms) which are incorporated by reference herein. Customer may request a copy of the terms and conditions from Lessor. If customer has previously executed a master agreement with Lessor, those terms and conditions shall govern the transaction. Such terms and conditions are incorporated as if fully set forth herein. No alterations, additions, exceptions, or changes to any Quotation or Agreement made by Lessee shall be effective against Lessor, whether made hereon, contained in any printed form of Lease or elsewhere, unless accepted in writing by Lessor. Any customer purchase order or other customer-provided document purporting to replace, supersede or supplement the terms and conditions of the Lessor's Lease shall carry no force or effect except as an instrument of billing.

Lessor:

Mobile Modular Management Corporation

By: _____

Name: _____

Title: _____

Date: _____

Lessee:

Calexico USD

Signature: _____

Print Name: _____

Title: _____

Date: _____

2. Request your delivery date.

Requested delivery date: _____

Please note: For modular buildings, as a "rule of thumb" allow one day per module to accommodate for set up after delivery. We will attempt to meet your desired date. However, the date is subject to change based on equipment availability and readiness and must be confirmed by a Mobile Modular representative.

3. Insurance value.

Prior to the scheduled delivery, please send, or have your insurance company send, a certificate of insurance referencing the Quotation number shown above. We require General Liability coverage in the amount of 1,000,000.00 per occurrence listing Mobile Modular Management Corporation as an additional insured and Property coverage for the value of the leased unit(s) listing Mobile Modular Management Corporation as loss payee.

Item & Description	Qty	Item Code	Insurance Value
Classroom, 24x40 DSA (Item1001)	1	1001	\$42,750.00
Classroom, 48x40 DSA (NonStd)	2	1683	\$257,400.00

4. Tell us how you would like to pay.

- ☐ Bill me on approved credit (you will be sent an invoice for payment as charges are incurred)
- ☐ Credit card payment (a representative will contact you to obtain the credit card information for billing)

Thank you for contacting Mobile Modular.

Mobile Modular is a division of McGrath RentCorp.
230712, 01-18-2019 10:24 AM prod

www.mobilemodular.com
Page 5 of 5